

106CS; 106CS20

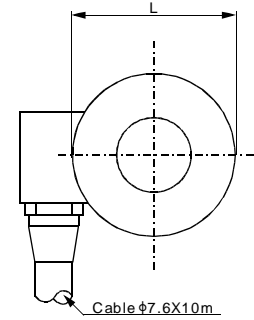

不锈钢

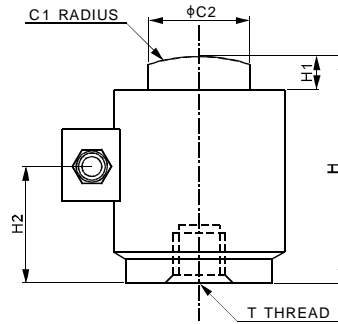

CE RoHS

尺寸

量程	C1	C2	H	H1	H2	L	T
lb/inches							
25,000...50,000	6.00	1.25	3.25	0.40	1.68	3.00	1/2-20 UNF-2B Depth0.31
100,000	6.00	2.31	5.00	0.51	2.49	4.00	3/4-16 UNF-2B Depth0.56
200,000	17.00	3.13	7.25	1.04	3.28	6.00	3/4-16 UNF-2B Depth0.75
kg/mm							
10,000...25,000	152.4	31.8	82.6	10.2	42.7	76.2	M12×1.75-6H Depth7.9
40,000...50,000	152.4	58.7	127.0	13.0	63.2	101.6	M20×2.50-6H Depth14.2
100,000	431.8	79.5	184.2	26.4	83.3	152.4	M20×2.50-6H Depth19.1

技术参数

相关量程	kg/lb	10t; 25t / 25K; 50K	40t; 60t / 100K	100t / 200K
产品毛重	kg/lb	3 / 6	6 / 13	13 / 28
灵敏度	mV/V	1.75 ± 0.25% (106CS); 2 ± 0.25% (106CS20)		
零位输出	mV/V	± 0.06		
非线性	%	< ± 0.023		
重复性	%	< ± 0.030		
滞后误差	%	< ± 0.030		
蠕变	%	< ± 0.030		
阻抗	Ω	480 ± 4.5		
额定激励电压	V(DC/AC)	10 (15V 最大)		
绝缘阻抗	GΩ	> 2 [50 VDC]		
正常工作温度范围	°C/°F	-10...40 / 14...104		
安全极限载荷	% of full scale	150		
破坏极限载荷	% of full scale	400		
密封方式		焊封, IP68		

可 选

- 耐高温 120°C [248°F]
- 公制和英制螺纹可选

可 互 换 产 品

制造商	型号
106CS	
Cardinal.....	CP1
Vishay Revere Transducers.....	CP
Vishay Revere Transducers.....	392B
106CS20	
Rice Lake.....	RLCSP1
Vishay Revere Transducers.....	CSP
Vishay Revere Transducers.....	692B